

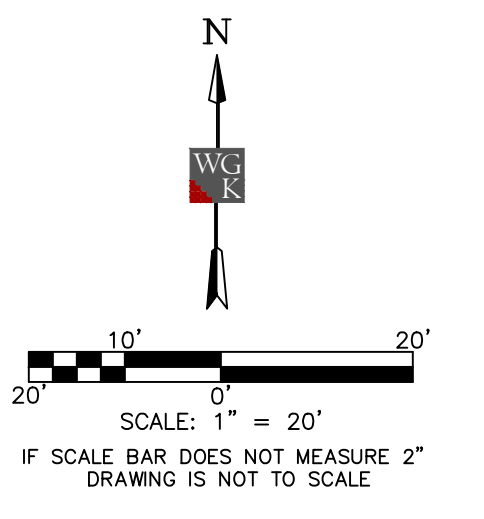

Meridian High School Baseball/Softball
2320 32nd St., Meridian, MS 39305

100% Construction Documents

Project No	22034-03
Date	March 6, 2023
Revisions	Rev Date
Rev. 4	April 19, 2023
Rev. 6	May 5, 2023



SHEET 601

SHEET 601
SHEET 603

- NOTES:**
- CONTRACTOR to remove/seal existing 15" RCP pipe connection to existing 36" RCP. CONTRACTOR to install junction box (typ.) to connect existing 2 - 36" RCP at existing 15" RCP pipe connection to be removed. CONTRACTOR to connect proposed trench drain from left field lounge area at elevation of 388.60.
 - CONTRACTOR to connect 6" Schedule 40 PVC at 5% minimum slope from proposed trench drain to proposed junction box. Only "sweep fittings" to be used to navigate elevation difference between trench drain invert and to get below proposed retaining wall footing to connect to proposed junction box structure. CONTRACTOR to provide 2-way cleanout before PVC storm pipe passes under the retaining wall. See grading plan for elevations.
 - CONTRACTOR to pour in place trench drain as per details. Bottom of trench drain to have minimum 0.5% slope in direction of outfall pipe. Minimum starting depth of 1' below bottom of grate. ADA grate required.

HORIZONTAL ORIENTATION DERIVED FROM GPS OBSERVATIONS AND NAD83(2011) GRID DATA, MISSISSIPPI STATE PLANE EAST ZONE, AND NAVD88 DATUM, HAVING A COMBINED FACTOR OF 0.99995186 AND A CONVERGENCE ANGLE OF (+)0°04'11.8731", AS SAMPLED AT WGK CONTROL POINT #2, AS SHOWN HEREON.
LOCATION OF UNDERGROUND UTILITIES SHOWN ON THIS PLAN IS APPROXIMATE ONLY, AND IS BASED ON SURFACE EVIDENCE OF SAME, OR INFORMATION PROVIDED BY MS 811 LOCATE SERVICES AND THE SCHOOL. OTHER UNDERGROUND UTILITIES/STRUCTURES MAY EXIST THAT WERE NOT EVIDENT TO SURVEYOR.

V:\Dale Partners\2023-349-00 Meridian High School Baseball_Softball_1\Production Drawings\Working\CS00 - Overall Drainage Plan.dwg/2023-10-10 AM

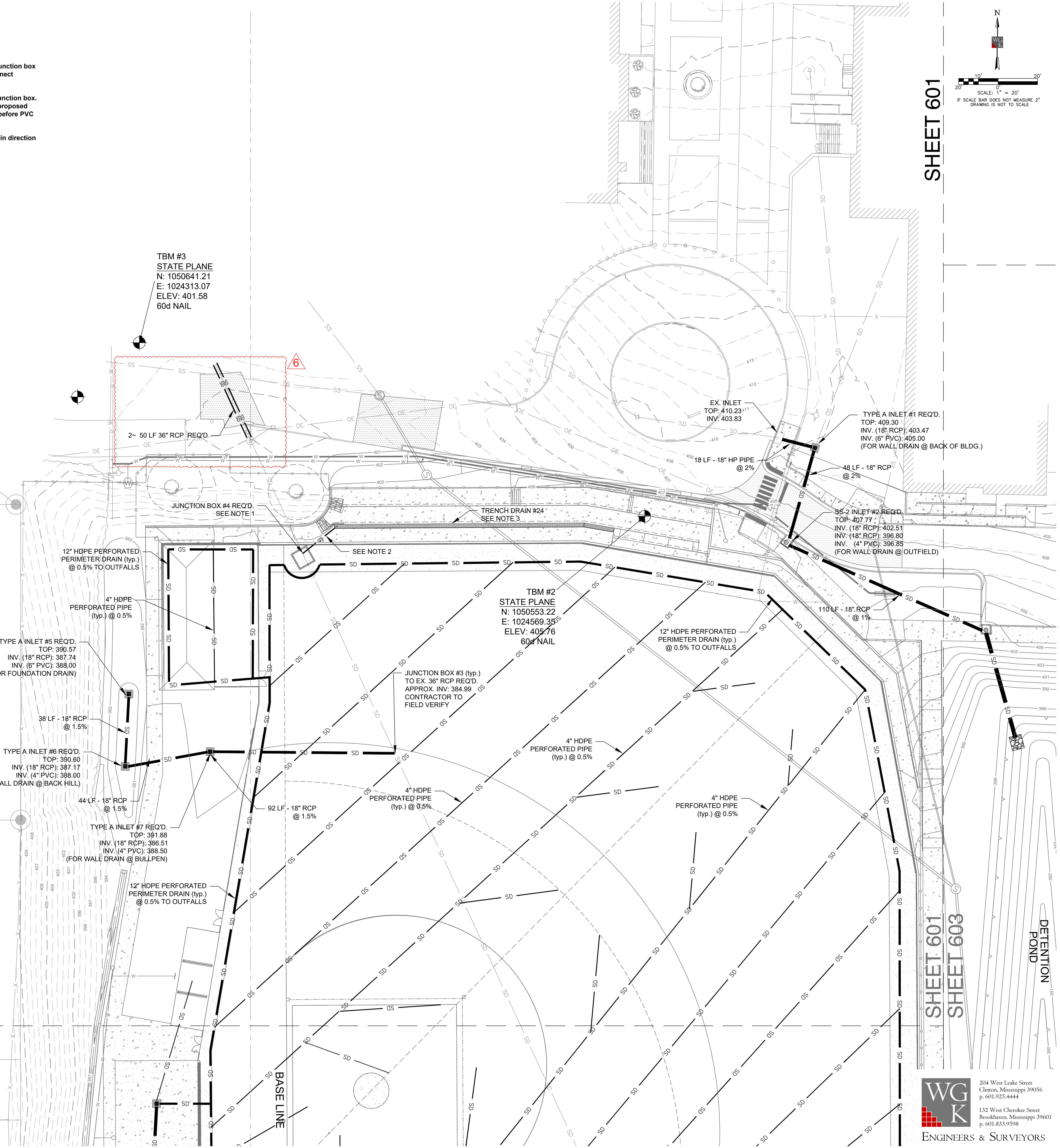

MATCHLINE SHEET 601
MATCHLINE SHEET 602

WGK
ENGINEERS & SURVEYORS
204 West Leake Street
Clinton, Mississippi 39056
p. 601.925.4444
132 West Cherokee Street
Brookhaven, Mississippi 39601
p. 601.833.9598